



RENAULT ZOE

Vehicle instruction manual: in the glove compartment

Fuel: 100% **electric**

Tyre pressure: see sticker on the pillar of the driver's door

Reverse gear



Push the button under the gear lever and shift to position R (reverse).

Adjust side mirrors

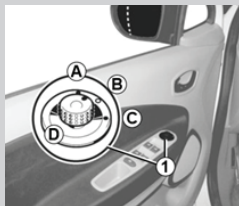

Use the controls by the handle of the driver's door.

A= adjust left mirror

C= adjust right mirror

B= neutral position

Air conditioning/Heating

- A. Automatic operation and air temperature adjustment
- B. 'Clear view' mode
- C. Turn air conditioning on or off
- D. Adjust fan speed

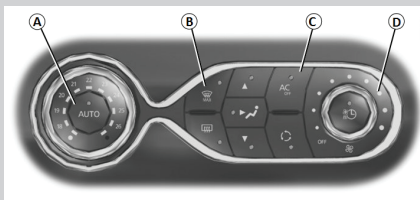

Start the car



Start/stop button

Insert the key card fully into the slot (2).

Keep the brake pedal depressed during the following steps: Push the start/stop button (1). The message READY lights up on the dashboard, and a short beep will sound.

To charge

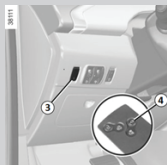

There is a charging socket at the front of the car. Connect the charging cable to the car and press the button on the key (4) or the button left of the steering wheel (3). If the cable has been attached correctly you will hear a slight hum.

Speed limiter / Cruise control



Use the switch next to the gear selector (1) to operate both the speed limiter and cruise control.

Use the dedicated controls to operate both functions:
2. activate, store in memory and increase speed
3. reduce speed
4. Turn off selected mode (speed will be stored)
5. Turn on and recall stored speed

Eco-Modus



Eco Mode is a function that optimizes the range of the vehicle but impacts speed, acceleration, heating, etc. The lower part of the dashboard lights green when eco mode is active. Press the **ECO** button next to the gear selector to turn eco mode on or off.

Headlights/Fog lights



Headlights: With the engine running, the headlights turn on automatically during the day without having to operate stalk 1. They turn off automatically when the engine stops.

Turn the collar in the middle to the O position. With the headlights switched on, pull stalk 1 towards you to activate the high beams.

Fog lights:

Rotate the middle collar on the stalk left of the steering wheel until the symbol is lined up with the mark, then release.

Windscreen wipers

Use the stalk right of the steering wheel to operate the windscreen wipers. Rote the collar in the middle until lined up with the symbol; select – to turn off.



Transmission – automatic

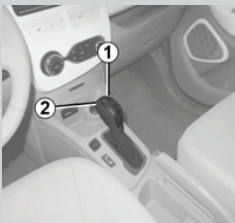

Automatic: use the right pedal only
The selected gear will be shown on the dashboard:

P: park

R: reverse

N: neutral

D: drive

To move the gear lever out of position P, depress the brake pedal before pushing the unlocking button.

Pedestrian horn

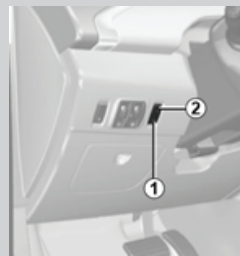

Electric cars are remarkably quiet. This system allows you to warn pedestrians and cyclists. The system is activated automatically when your speed is between 1 and 30 km/h. With the engine running, press the switch **(1)** to turn the function on or off. The integrated warning light **(2)** indicates if the function is on or off.

Spare wheel

This car does not carry a spare wheel. A repair kit is stored under the trunk floor, along with a jack and wheel wrench.

Notes
